

# Push button series WTL Touchless

- **Contactless release**
- Additional **push release**
- Braille writing
- Taktile symbols
- Front foil freely designed
- 40mm operating push area
- Window segment: LED green/red
- CE

## Description:

The WTL button series is used to trigger a switching function with a finger pressure or a non-contact gesture with the hand (e.g. „waving movement“) directly in front of the button surface.

Examples of use are e.g., in the public area for triggering:

- Elevator call
- Opening / closing / locking a door
- Toilet flushing / hand dryer / hand wash water

The additional function, for which a patent is pending, can also be integrated into buttons from other manufacturers.

## Technical Data:

- Switching element:  
24V DC / 100mA
- LEDs: typ. 24V DC / 20mA
- Optical release distance:  
approx 100mm
- Mechanical actuation force:  
approx: 3.5N
- Service life of probe element:  
typ. 1 million cycles
- Connection terminals:  
Spring clamp terminal WAGO 236

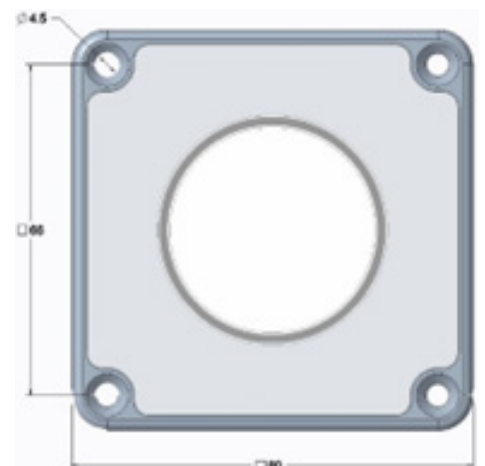
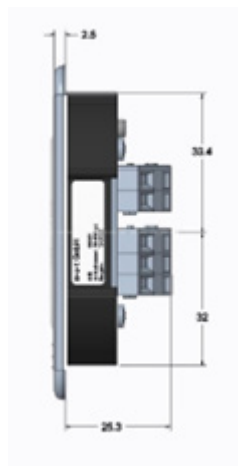

## Diagram:

